

Latches with Cabinet U-Handle

Zinc Die Casting, Operation with Socket Key

SPECIFICATION

Types

- Type **DK**: With triangular spindle
- Type **VK7**: With square spindle
- Type **VK8**: With square spindle
- Type **SCH**: With slot
- Type **VDE**: With double bit

Cabinet U-handle

Zinc die casting
Powder coated

- Black, RAL 9005, textured finish **SW**
- Silver, RAL 9006, textured finish **SR**

Other parts

Steel
Zinc plated, blue passivated



INFORMATION

Latches with cabinet U-handle GN 115.7 are used when the application requires both a locking mechanism and a handle. They lock by a turning operation limited to 90° which moves the latch arm in the locked position behind the door frame. The bevels of the latch arm ease the closing of the door.

Latch arms are available with different bend angles to cover a latch arm distance A from 4 to 50 mm. The latches with cabinet U-handle GN 115.7 are supplied with loosely enclosed latch arm.

The cabinet U-handle with integrated latch arm is an attractively designed and cost-effective solution.

ACCESSORY

- GN 119.2 Socket Keys (see page 1530)
- GN 120.2 Protective Guide Plates (see page 1479)
- GN 120.3 Internal Cabinet Handles (see page)

TECHNICAL INFORMATION

- List of latch types (see page 1456)

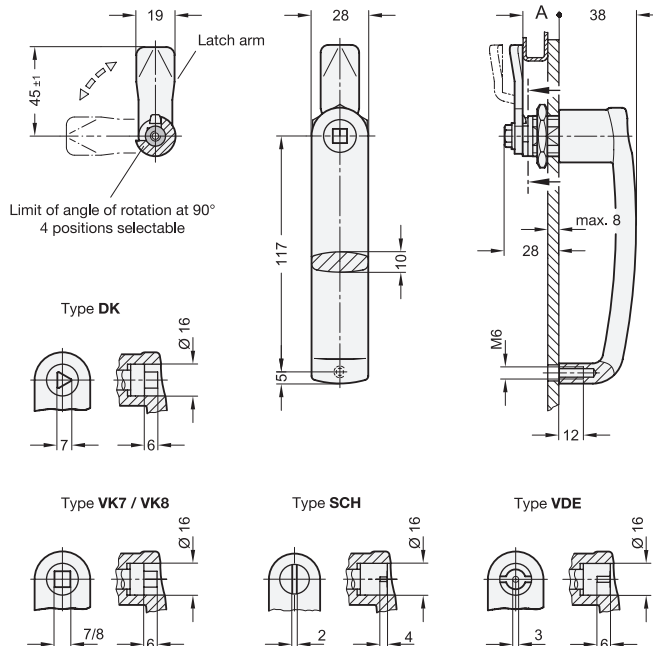

* Complete with

SW RAL9005 SR RAL9006

GN 115.7-DK

Description	Latch distance A	⚖
GN 115.7-DK-4-*	4	401
GN 115.7-DK-6-*	6	398
GN 115.7-DK-8-*	8	399
GN 115.7-DK-10-*	10	398
GN 115.7-DK-13-*	13	398
GN 115.7-DK-14-*	14	398
GN 115.7-DK-16-*	16	391
GN 115.7-DK-18-*	18	396
GN 115.7-DK-20-*	20	396
GN 115.7-DK-22-*	22	397
GN 115.7-DK-24-*	24	397
GN 115.7-DK-26-*	26	399
GN 115.7-DK-28-*	28	399
GN 115.7-DK-30-*	30	400
GN 115.7-DK-32-*	32	401
GN 115.7-DK-34-*	34	403
GN 115.7-DK-36-*	36	401
GN 115.7-DK-38-*	38	406
GN 115.7-DK-40-*	40	409
GN 115.7-DK-42-*	42	408
GN 115.7-DK-45-*	45	401
GN 115.7-DK-50-*	50	413

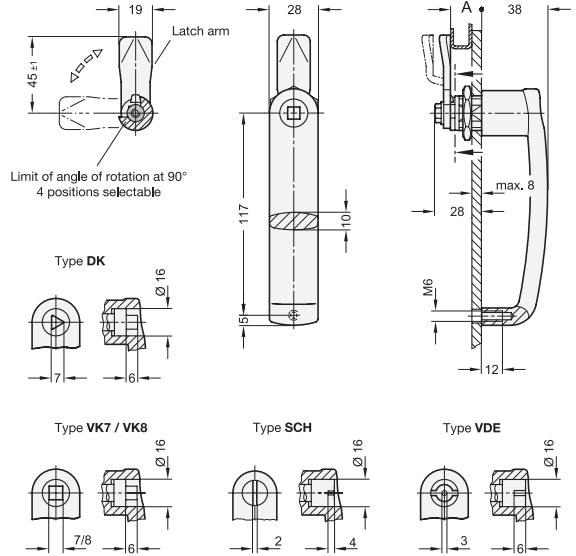

GN 115.7-VK7

Description	Latch distance A	⚖
GN 115.7-VK7-4-*	4	401
GN 115.7-VK7-6-*	6	398
GN 115.7-VK7-8-*	8	399
GN 115.7-VK7-10-*	10	398
GN 115.7-VK7-13-*	13	398
GN 115.7-VK7-14-*	14	398
GN 115.7-VK7-16-*	16	391
GN 115.7-VK7-18-*	18	396
GN 115.7-VK7-20-*	20	397
GN 115.7-VK7-22-*	22	397
GN 115.7-VK7-24-*	24	398
GN 115.7-VK7-26-*	26	399
GN 115.7-VK7-28-*	28	399
GN 115.7-VK7-30-*	30	400
GN 115.7-VK7-32-*	32	401
GN 115.7-VK7-34-*	34	403
GN 115.7-VK7-36-*	36	401
GN 115.7-VK7-38-*	38	406
GN 115.7-VK7-40-*	40	409
GN 115.7-VK7-42-*	42	408
GN 115.7-VK7-45-*	45	401
GN 115.7-VK7-50-*	50	413

GN 115.7-VK8

Description	Latch distance A	⚖
GN 115.7-VK8-4-*	4	402
GN 115.7-VK8-6-*	6	399
GN 115.7-VK8-8-*	8	400
GN 115.7-VK8-10-*	10	399
GN 115.7-VK8-13-*	13	399
GN 115.7-VK8-14-*	14	399
GN 115.7-VK8-16-*	16	392
GN 115.7-VK8-18-*	18	397
GN 115.7-VK8-20-*	20	398
GN 115.7-VK8-22-*	22	398
GN 115.7-VK8-24-*	24	399
GN 115.7-VK8-26-*	26	400
GN 115.7-VK8-28-*	28	400
GN 115.7-VK8-30-*	30	401
GN 115.7-VK8-32-*	32	402
GN 115.7-VK8-34-*	34	404
GN 115.7-VK8-36-*	36	402
GN 115.7-VK8-38-*	38	407
GN 115.7-VK8-40-*	40	410
GN 115.7-VK8-42-*	42	409
GN 115.7-VK8-45-*	45	402
GN 115.7-VK8-50-*	50	414

Weight SW

Weight SW



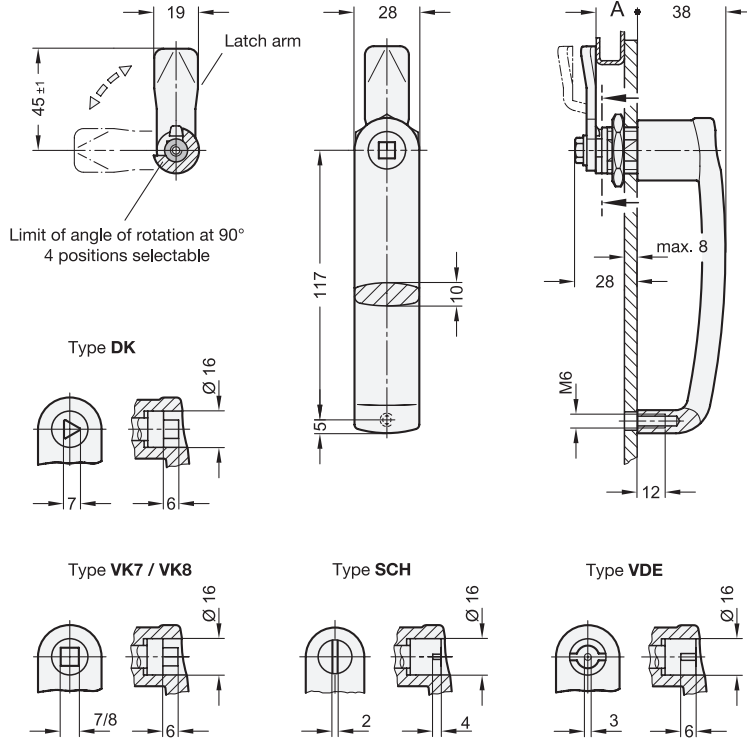

* Complete with
SW SR
 RAL9005 RAL9006

GN 115.7-SCH

Description	Latch distance A	⚖
GN 115.7-SCH-4-*	4	409
GN 115.7-SCH-6-*	6	406
GN 115.7-SCH-8-*	8	407
GN 115.7-SCH-10-*	10	406
GN 115.7-SCH-13-*	13	406
GN 115.7-SCH-14-*	14	406
GN 115.7-SCH-16-*	16	399
GN 115.7-SCH-18-*	18	404
GN 115.7-SCH-20-*	20	405
GN 115.7-SCH-22-*	22	405
GN 115.7-SCH-24-*	24	406
GN 115.7-SCH-26-*	26	407
GN 115.7-SCH-28-*	28	407
GN 115.7-SCH-30-*	30	408
GN 115.7-SCH-32-*	32	409
GN 115.7-SCH-34-*	34	411
GN 115.7-SCH-36-*	36	409
GN 115.7-SCH-38-*	38	414
GN 115.7-SCH-40-*	40	417
GN 115.7-SCH-42-*	42	416
GN 115.7-SCH-45-*	45	409
GN 115.7-SCH-50-*	50	421

GN 115.7-VDE

Description	Latch distance A	⚖
GN 115.7-VDE-4-*	4	403
GN 115.7-VDE-6-*	6	400
GN 115.7-VDE-8-*	8	401
GN 115.7-VDE-10-*	10	400
GN 115.7-VDE-13-*	13	400
GN 115.7-VDE-14-*	14	400
GN 115.7-VDE-16-*	16	393
GN 115.7-VDE-18-*	18	398
GN 115.7-VDE-20-*	20	399
GN 115.7-VDE-22-*	22	399
GN 115.7-VDE-24-*	24	399
GN 115.7-VDE-26-*	26	401
GN 115.7-VDE-28-*	28	401
GN 115.7-VDE-30-*	30	402
GN 115.7-VDE-32-*	32	403
GN 115.7-VDE-34-*	34	405
GN 115.7-VDE-36-*	36	403
GN 115.7-VDE-38-*	38	408
GN 115.7-VDE-40-*	40	411
GN 115.7-VDE-42-*	42	410
GN 115.7-VDE-45-*	45	403
GN 115.7-VDE-50-*	50	415

Weight SW

Weight SW

Latches 13

Technical and assembly instructions

Depending on the installation situation, the 90° turning range of the latch arm can be defined by means of a plug-type element, which can be mounted in 4 different positions.

This allows the latch with U-handle to be used in any attachment position and regardless of the turning and locking direction or of the narrow side of the door. Subsequent repositioning of the 90° rotary range is possible, if necessary.

The possible plugging options and the resulting 90° rotary ranges are shown in the outline drawing.

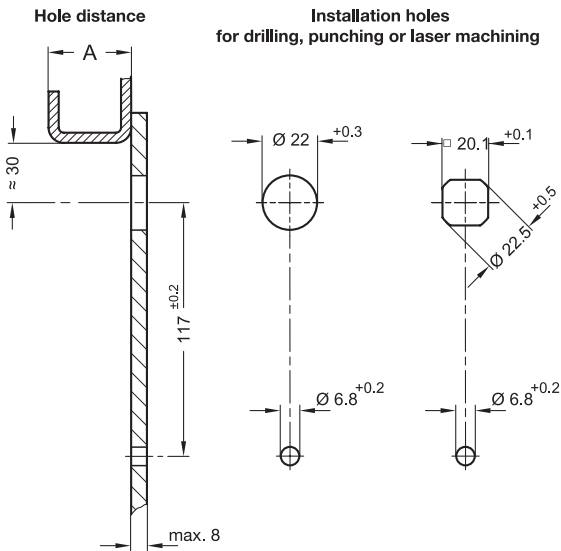
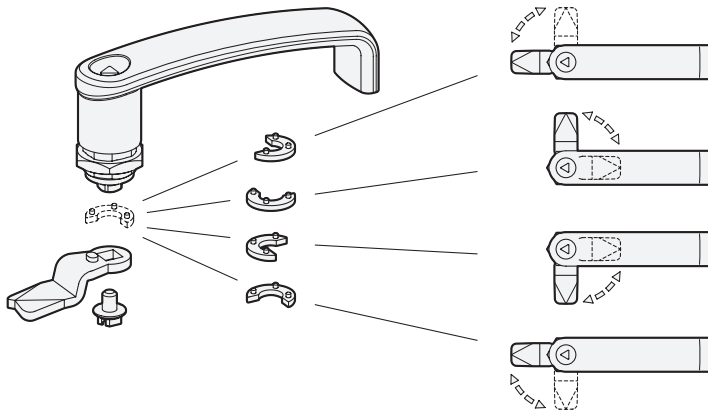

For installation, the door, cover or hatch is fitted with two holes according to one of the two outline drawings.

If preassembled (cabinet U-handle including latch arm), the latch can be inserted through the hole from the front. The mounting nut can then be pushed over the latch from the back and bolted in place. The second end of the cabinet U-handle is secured with an M6 mounting screw (not included). Finally, both elements are tightened.

The required installation holes in the door leaf, is usually generated by punching or laser machining in series production.

